



ORIENTAL MOTOR U.S.A. Corp.  
570 Alaska Avenue  
Torrance, CA 90503  
1-800-GO-VEXTA (468-3982)

## Item # CVD223-K, CVD 2-Phase Bipolar Driver (24 VDC)

2-phase, fully digital, bipolar microstepping driver, CVD

- 32 Motor Resolution Settings
- Low Vibration Driver type



Web Price

**\$157.00**

[Specifications](#) | [Dimensions](#) | [Connection](#) | [System](#)

### Specifications

Lead Time <sup>1</sup>	Up to 5 pcs as of 6:30am EST Estimated Ship: 02/09/2026
Driver Type	2-Phase, Pulse Input
Driver	Board Type
Power Supply	24 VDC
Input Current	2 A
Output Current	0.58 ~ 2.3 A/phase
Excitation Mode	Microstep
Lead Wires	4
RoHS Compliant	These products do not contain substances that exceed the regulation values in the RoHS Directive.
Safety Standards	CE



**California Proposition 65****⚠ CA WARNING**

Cancer risk from exposure to Nickel. See [www.P65Warnings.ca.gov](http://www.P65Warnings.ca.gov)

Risk of reproductive harm from exposure to Di-n-hexyl phthalate (DnHP). See [www.P65Warnings.ca.gov](http://www.P65Warnings.ca.gov)

Risk of cancer and reproductive harm from exposure to Di(2-ethylhexyl phthalate (DEHP). See [www.P65Warnings.ca.gov](http://www.P65Warnings.ca.gov)

See "?" or copy/paste [www.P65Warnings.ca.gov](http://www.P65Warnings.ca.gov) in your browser.

**Dimensions****● Driver Unit = mm (in.)**

Driver Product Name: CVD205-K, CVD215-K, CVD223-K, CVD228-K,  
CVD503-K, CVD507-K, CVD512-K, CVD514-K, CV518-K, CVD524-K

Mass: 0.02 kg (0.71 oz)

**CAD** B1128

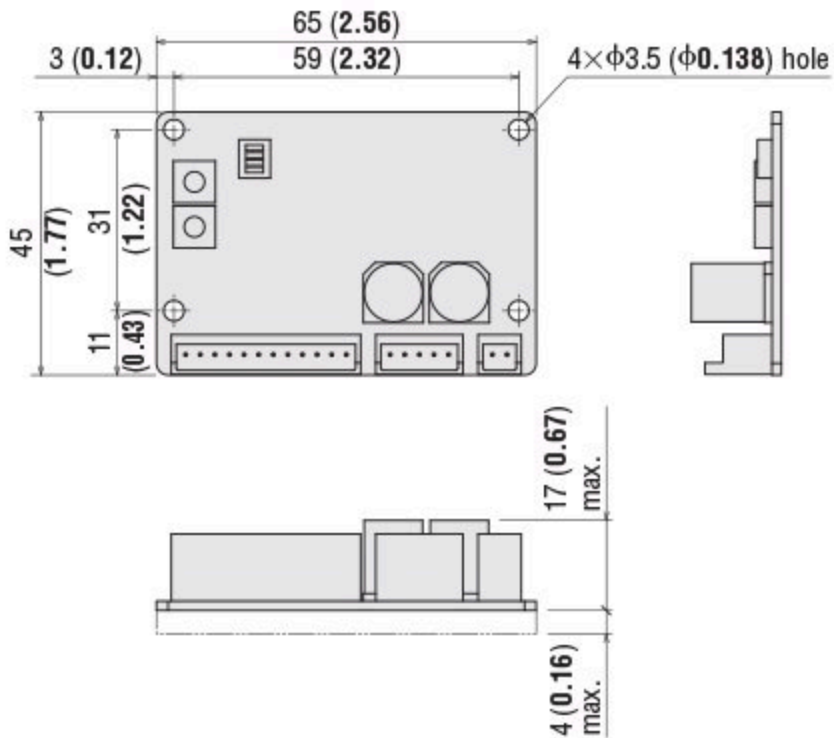
**● Included**

Connector housing: 51103-0200  
51103-0500  
51103-1200  
Connector: 50351-8100 (Molex)

**Connection**

## Connection Diagram

### When the Pulse Input is the Line Driver

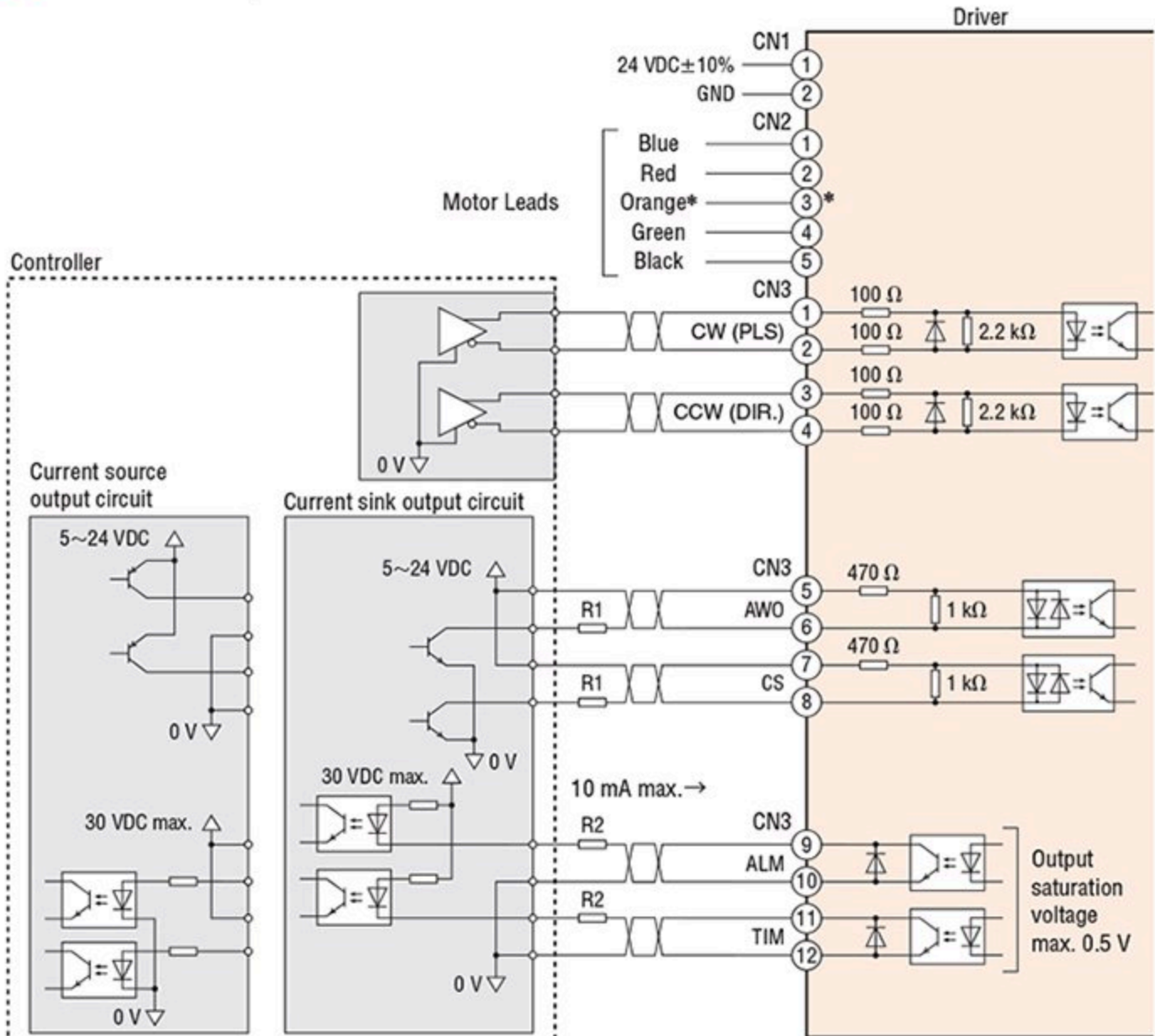

\*Not available on a 1.8° stepper motor. Do not connect anything to Pin No.3.

### When the Pulse Input is the Open Collector

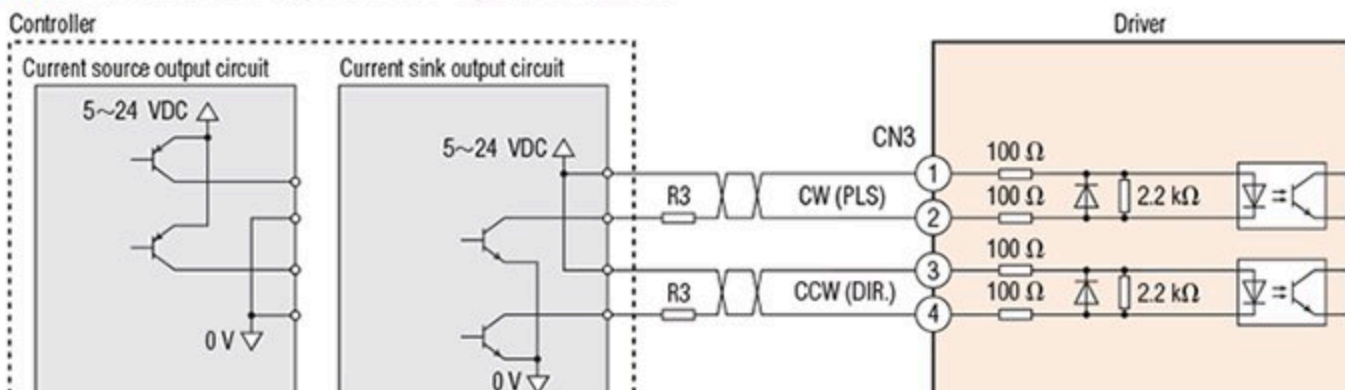

[Note on Wiring]

## ◇ I/O Signal Connection

### ● Input signal

Use 5 VDC for input signal.

When applying a voltage that exceeds 5 VDC, connect an external resistor R1 so that the current is between 5~15 mA. (AWO, CS)

When the pulse is input by an open collector and a voltage that exceeds 5 VDC for CW input and CCQ input is going to be applied, connect an external resistor R3 so that the current is between 5~15 mA.

### ● Output signal

For output signal, please use 30 VDC, 10 mA or less. When the current value exceeds 10 mA, please connect an external resistor R2.

### ● Use a twisted-pair wire AWG24~22 (0.2~0.3 mm<sup>2</sup>).

### ● Since the maximum transmissible frequency drops as the pulse line becomes longer, keep the wiring length as short as possible within 2 m (6.6 ft.).

### ● Provide a distance of 100 mm (3.94 in.) min. between the I/O signal lines and power lines (power supply lines, motor lines, etc.).

## ◇ Power Supply Connection

### ● Use AWG22 (0.3 mm<sup>2</sup>) wires.

### ● Incorrect polarities of the DC power-supply input will lead to driver damage. Make sure that the polarity is correct before turning the power on.

## ◇ Extension of Motor Cable

### ● Use AWG22 (0.3 mm<sup>2</sup>) or thicker wires.

## ◇ General

### ● A separate hand crimp tool is required to crimp the supplied power connector included and lead wire. Accessory connection cables (sold separately) are crimped lead wires.

### ● If noise generated by the motor cable or power supply cable causes a problem with the specific wiring or layout, shield the cable or use ferrite cores.

## System Configuration

An example of a system configuration with the **SCX11** controller shown below.

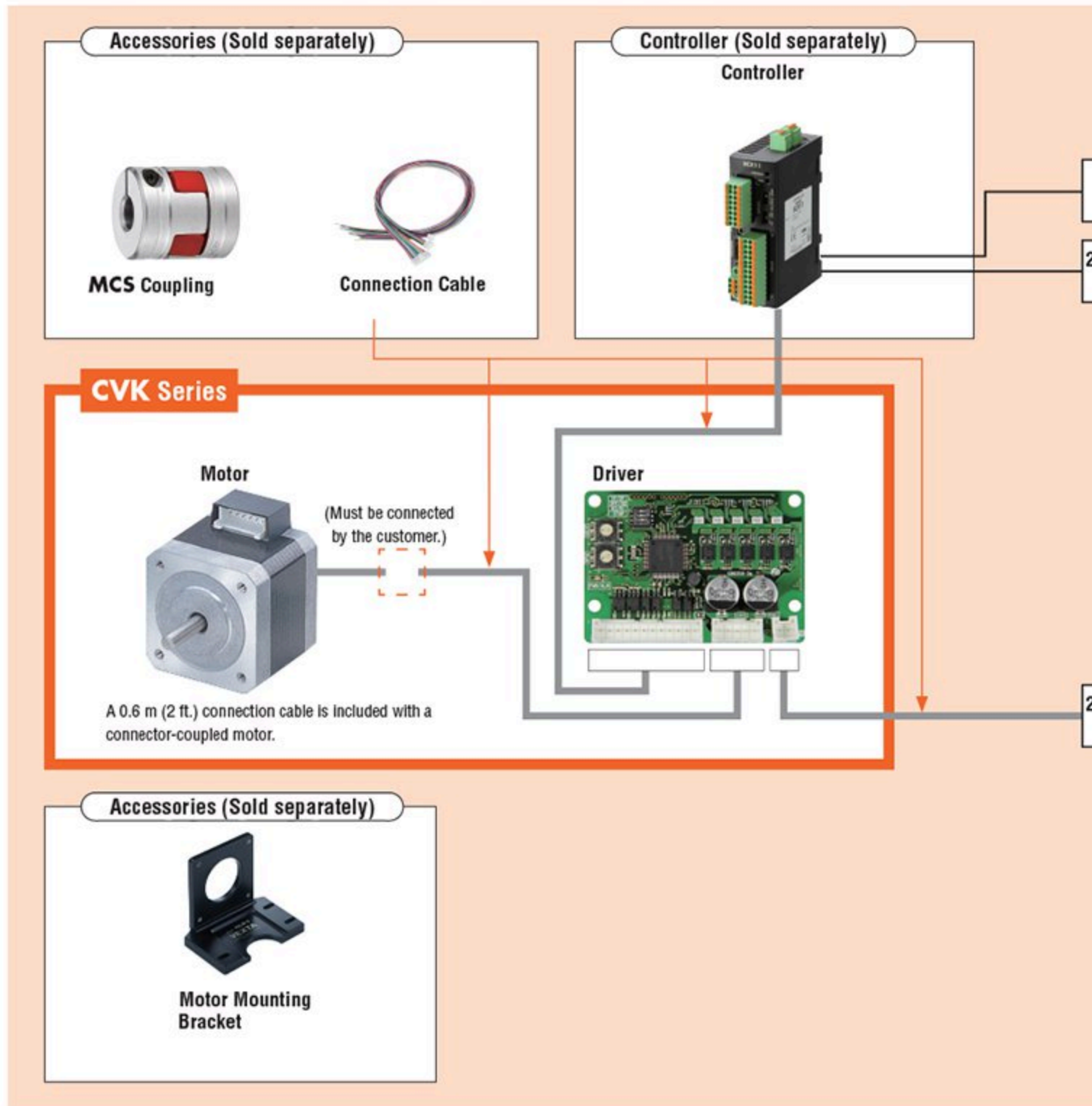

<sup>1</sup> Quoted Ship Date for orders placed before 12:00 pm PST. Quantities may affect Shipping Date.

Site Search...

