

Oriental motor

ORIENTAL MOTOR U.S.A. Corp.
570 Alaska Avenue
Torrance, CA 90503
1-800-GO-VEXTA (468-3982)

Item # BLM6200SHP-GFV / GFV6G15S, 200 W (1/4 HP) Brushless DC Motor Parallel Shaft Gearhead (15:1 Gear Ratio)



The BLM Series features a compact, high-power and high-efficiency brushless DC motor. The entire motor structure features our latest brushless DC motor technology and has been innovated in pursuit of the optimal performance.

*Connection Cable Required.



Web Price

\$511.00

[Specifications](#) | [Speed-Torque](#) | [Dimensions](#) | [System](#)

Specifications

Lead Time¹	Available quantity to ship: 5 pieces by 4/27/26.
Motor Type	Brushless DC Motor
Motor Frame Size	4.33 in.
Output Power	200 W (1/4 HP)
Power Input	AC
Shaft/Gear Type	Parallel Shaft Gearhead
Gear Ratio (X:1)	15 :1
Output Shaft Diameter	22 mm
Rated Torque	76 lb-in
Electromagnetic Brake	Not Equipped



Variable Speed Range (r/min)	5.3 ~ 267
Permissible Load Inertia	5500 oz-in ² *When instantaneous stop or instantaneous bi-directional operation is performed = 2500 oz-in ²
Permissible Radial Load	0.39 in. from Shaft End = 123 lb 0.79 in. from Shaft End = 180 lb
Permissible Axial Load	45 lb
Components	BLM6200SHP-GFV , 200 W (1/4 HP) BLE2 Series Brushless DC Motors Brushless DC Pinion Shaft Motor (\$245.00) GFV6G15S , GFV Series Parallel Shaft Gearhead (15:1) (Metric Shaft) (\$266.00)
RoHS Compliant	These products do not contain substances that exceed the regulation values in the RoHS Directive.
Safety Standards	UL CSA CE
CE Marking	Low Voltage Directives EMC Directives
California Proposition 65	⚠ CA WARNING Cancer risk from exposure to Nickel. See www.P65Warnings.ca.gov Risk of reproductive harm from exposure to Di-n-hexyl phthalate (DnHP). See www.P65Warnings.ca.gov Risk of cancer and reproductive harm from exposure to Di(2-ethylhexyl phthalate (DEHP). See www.P65Warnings.ca.gov See "?" or copy/paste www.P65Warnings.ca.gov in your browser.
Insulation Resistance (Motor)	100 MΩ or more when 500 VDC megger is applied between the windings and the case after continuous operation under normal ambient temperature and humidity.
Dielectric Strength (Motor)	Sufficient to withstand 1.5 kVAC at 50 Hz applied between the windings and the case for 1 minute after continuous operation under normal ambient temperature and humidity.
Temperature Rise (Motor)	The temperature rise of the windings is 90°F (50°C) and that of the case is 72°F (40°C) when measured by the thermocouple method after rated continuous operation under normal ambient temperature and humidity.
Ambient Temperature Range	Motor: 32°F ~ 104°F (0°C ~ 40°C), nonfreezing Driver: 32°F ~ 122°F (0°C ~ 50°C)
Ambient Humidity	85% or less, noncondensing
Altitude	Up to 3300 ft (1000 m) above sea level.

Operating Atmosphere	No corrosive gases or dust. Cannot be used in a radioactive area, magnetic field, vacuum or other special environment.
Thermal Class	CSA standards: 105 (A), EN standards: 120 (E) UL
Degree of Protection	Motor: IP66

Speed-Torque

Speed – Torque Characteristics

Continuous Duty Region: Continuous operation is possible in this region.

Limited Duty Region: This region is used primarily when accelerating.

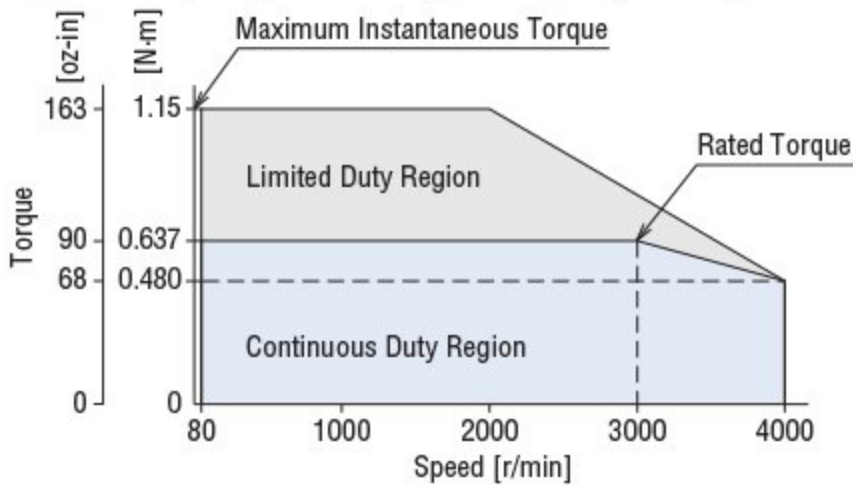

Dimensions

● Dimensions for Installation Screws

◇ Parallel Shaft Gearhead

BMU, BLE2, BXII and BLH Series

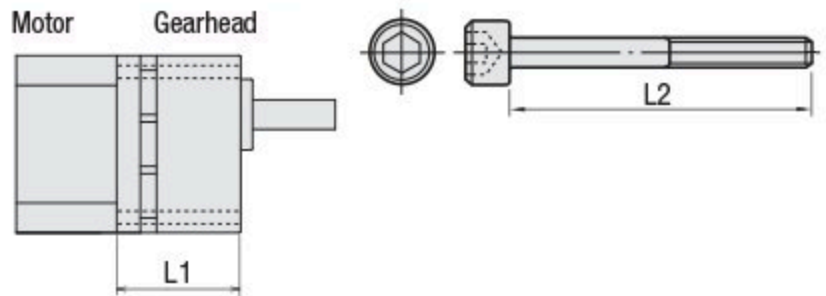

Gearhead		Installation Screw	
Product Name	L1 (mm)	L2 (mm)	Screw Size
GFV2G5~20S	42	50	M4 P0.7
GFV2G30~100S	46	55	
GFV2G200S	51	60	
GFV4G5~20S	49	60	M6 P1.0
GFV4G30~100S	54	65	
GFV4G200S	59	70	
GFV5G5~20S	55	70	M8 P1.25
GFV5G30~100S	68	85	
GFV5G200S	74	90	
GFV6G5~20S	70	85	
GFV6G30~50S	82	100	
GFV6G100~200S	96	110	
GFS2G5~20	42	50	M4 P0.7
GFS2G30~100	46	55	
GFS2G200	51	60	
GFS4G5~20	49	65	M6 P1.0
GFS4G30~100	54	70	
GFS4G200	59	75	
GFS5G5~20	55	75	M8 P1.25
GFS5G30~100	68	90	
GFS5G200	74	95	
GFS6G5~20	70	95	
GFS6G30~50	82	110	
GFS6G100~200	96	120	

● Installation screws for **GFV■G□S**:

Flat washers and spring washers are included four pieces each.

The material of the installation screws are stainless steel.

● Installation screws for **GFS■G□**:

Flat washers, spring washers and hexagonal nuts are included four pieces each.

DIMENSIONS IN MILLIMETERS [INCHES]

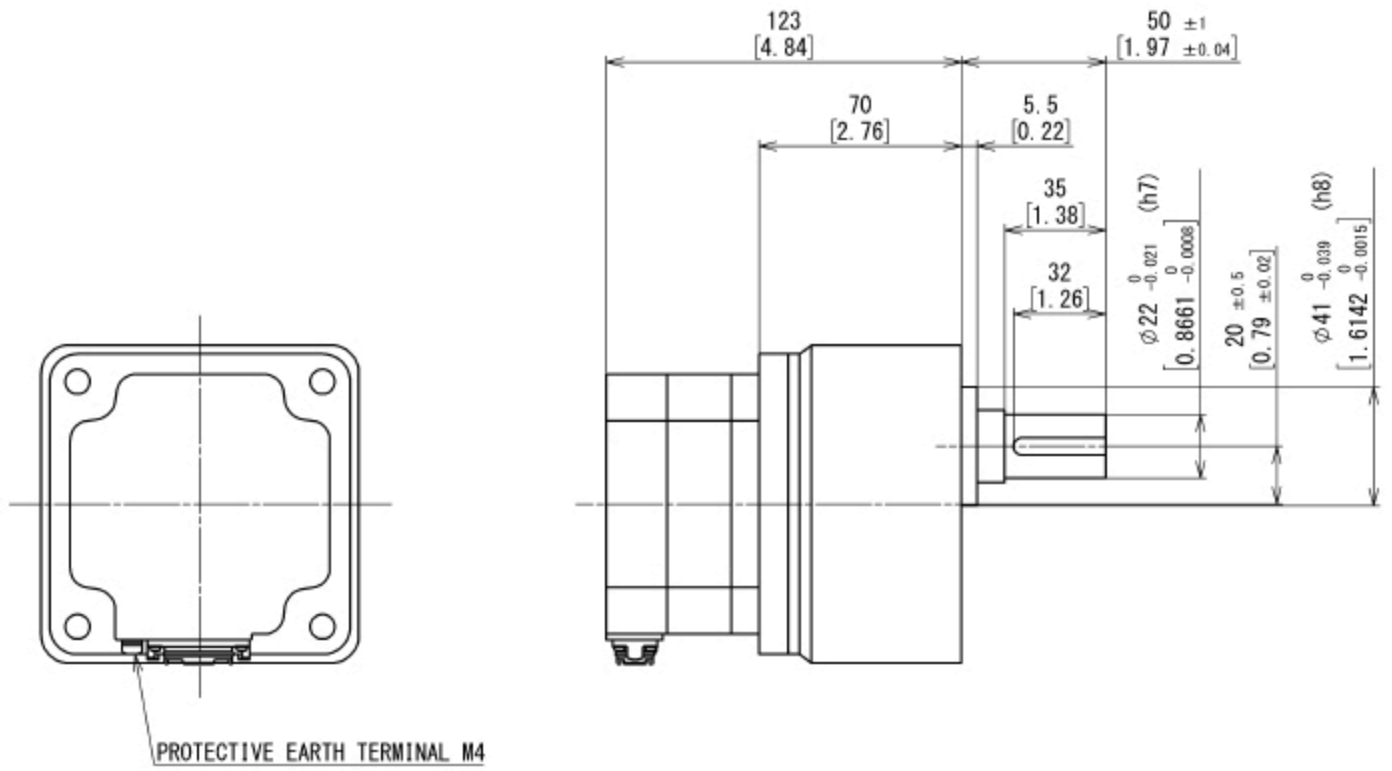

SELECTABLE CABLE OUTLET DIRECTION (FREE)

VERTICAL SIDE	OUTPUT SHAFT SIDE	OPPOSITE SIDE OF OUTPUT SHAFT
<p>2 [0.08]</p> <p>31 [1.22]</p>	<p>2 [0.08]</p> <p>15 [0.59]</p>	<p>19 [0.75]</p> <p>15 [0.59]</p>

System Configuration

Motors, gearheads, drivers, and connection cables must be ordered individually.

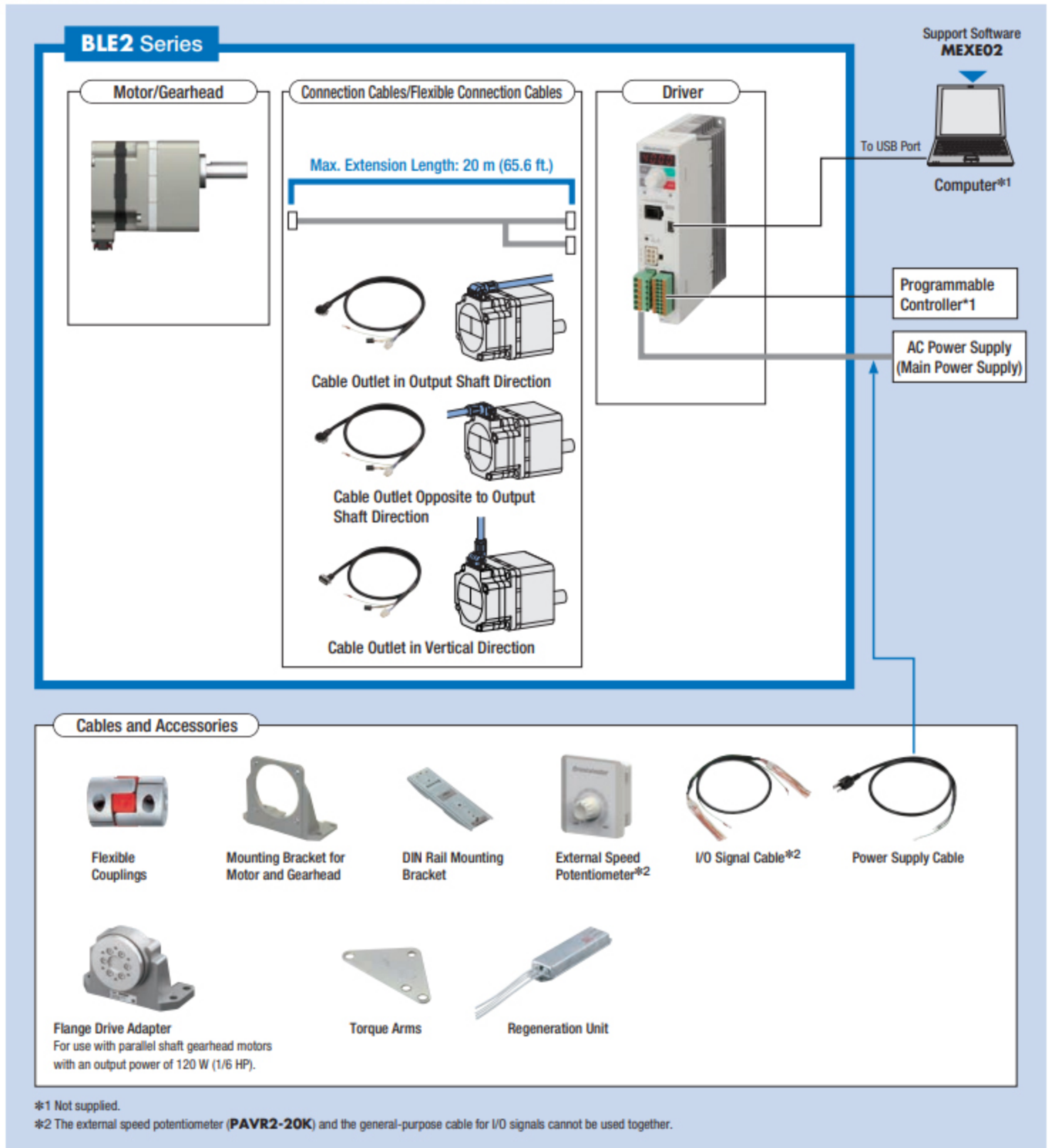

*1 Not supplied.

*2 The external speed potentiometer (PAVR2-20K) and the general-purpose cable for I/O signals cannot be used together.

● Example of System Configuration

BLE2 Series				Peripheral Equipment		
Motor	Gearhead	Driver	Connection Cable [3 m (9.8 ft.)]	Mounting Brackets	Flexible Couplings	DIN Rail Mounting Bracket
BLM230HP-GFV	GFV2G10S	BLE2D30-A	CC030KHBLV	SOL2M4F	MCL301010	MADPO2

● The system configuration shown above is an example. Other combinations are also available.

¹ Quoted Ship Date for orders placed before 12:00 pm PST. Quantities may affect Shipping Date.

©2017 - ORIENTAL MOTOR U.S.A. Corp. - All rights reserved.

Site Search...

